

Limit Switch

HER

Leaflet No. **Kiepe 447**



APPLICATION

The limit switch HER has been designed for a maximum of safe operation under severe conditions to become installed in any bulk handling system. All external parts are either of stainless steel or have been specially plated.

The trip points - both preset at 10° - can be changed within 5 and 15° resp. 15 and 35° by means of adjustable cams.

The roller lever is continuously adjustable on the shaft. For safety applications the lever has to be bolted with the shaft.

The positiv making and selfcleaning switching elements also qualify the switch to be used the classical relay circuits as well as cable signalling devices such as field buses.

TECHNICAL DATA

Device complies with	EN 60947-5-1 EN 60204 VDE 0110 - Degree of Pollution 2
Enclosure	Aluminium alloy, GK-ALSi12
Actuating roller lever	Roller: CuZn39Pb3, lever: AlMgSi1
Finish	2-component DD-tile enamel yellow, RAL 1004
Fastening	2 oblong holes for M 8-bolts
Cable entry	2 x M 25 x 1,5
Protection	IP 67 according to EN 60529
Rated insulation voltage U_i	AC 380 V, DC 250 V
Earthing	Within enclosure, M5
Admissible ambient temperature ¹⁾	-25 °C ... +70 °C
Switching elements	Snap acting switches, positive making and self cleaning
Number of contacts	2 changeover contacts SPDT
Conventional thermal current I_{th}	10 A
Breaking capacity I_e/U_e	4 A/AC 230 V
Connections	2,5 mm ²
Mechanical life	0,5 x 10 ⁶ switching cycles
Excursion	75° max.
Maintenance	Free
Ordering code	92.057.020.606

¹⁾ Deviating ambient temperature upon request

Note: The devices may be used in control circuits only!

DIMENSIONS

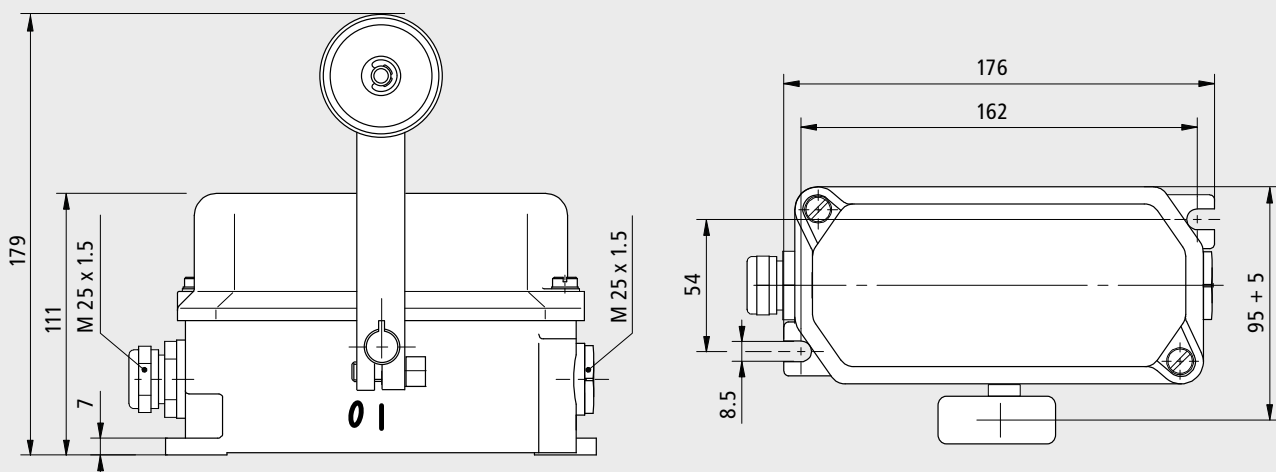

Subject to change without notice.